



AcoustiPack™

Ultimate Noise Reduction



Acoustic Materials Pack Contents and Fitting Recommendations

Pack Contents

AcoustiPack™ Standard contains 3 pieces of material:

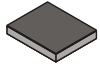

Acoustic Composite (3 pieces) with self-adhesive backing.

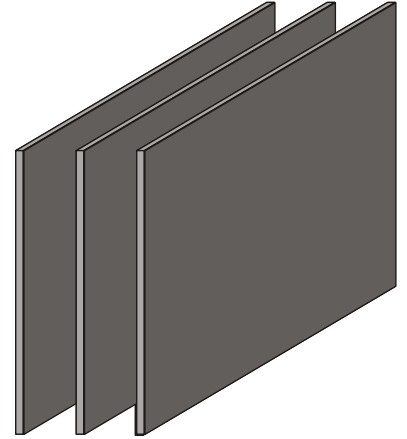

Fitting Recommendations

It is **IMPORTANT** that the materials in this AcoustiPack™ are carefully installed - please take a moment to read the following recommendations.

Before installation, plan where to locate the largest pieces of cut material. Once these have been measured and cut, it will reveal how much of the remaining material can be used for more intricate locations. Where self-adhesive is on the reverse of the materials, remove the backing paper and adhere lightly to clean, dust-free surfaces. If you make a mistake positioning materials - they can be re-applied for a second attempt - but be aware that excessive re-application will cause a deterioration in the adhesive. Once materials are well positioned, press **firmly** into place. After installation we recommend that system and component temperatures are monitored. For more information see <http://www.acoustiproducts.com> and click on 'Products' then 'AcoustiPack™'.

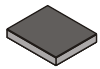

Acoustic Composite Sheets

It is best to arrange the acoustic composite sheets so that the foam side is exposed to sources of noise. Avoid adhering the materials to printed circuitry or internal components. The composite sheets can typically be located on case sides, roof and floor.



Important! READ THIS BEFORE installing the materials in this pack:

- DO NOT cover the ventilation holes at the rear of the case with any materials.
- DO NOT position the rear of the case close to a permanent heat source, such as a radiator, or very close to an airflow obstruction, such as a wall. This may inhibit air circulation required for cooling. Leave a gap at the rear of the case of at least 20cm to allow free movement of air in and out of the case.
- DO NOT position materials inside the case in such a way that may inhibit the correct functioning of any internal components, especially cooling fans, disc drives and moving parts. These components require adequate space and ventilation. Whilst every care has been taken to produce a set of effective acoustic materials, it is the responsibility of the machine builder to position the materials appropriately to facilitate normal functioning of internal components.
- These materials are installed at the installer's own risk.

APS v1.2